

HTM

PSU4 TRANSMITTER POWER SUPPLY UNIT

FEATURES

- ❖ Short circuit current limiting
- ❖ Regulated output voltage
- ❖ 4 channels in one unit
- ❖ Independent channel output
- ❖ Low power consumption
- ❖ Compact casing

INTRODUCTION

In instrumentation system, when all loop powered 4-20mA instruments are powered by a common power supply unit. Failure or short circuit in one particular instrument loop not only affect the performance of all the loops, the large capacity of the power supply unit used may burnt some of the components in the short circuited loop. This will cause unnecessary damage to the instrumentation system.

APPLICATIONS

HTM PSU4 Transmitter Power Supply Units are the ideal power supply units for powering instrumentation transmitters using loop powered 4-20mA DC signal. The units are equipped with four channels of 24VDC power supplies that are independent, voltage regulated and current limiting. In the event of short circuit in a particular instrument loop, the current output of the connected channel will be limited to a maximum of 33mA while providing sufficient current to the other channels. This prevents instruments in the affected loop from damaged by excessive short circuit current and at the same time maintain performance of other loops.



DESIGN

HTM PSU4 Transmitter Power Supply Units are simple power supply units that are constructed from readily available electronic components. No special parts are used and therefore can be repaired or modified by any electricians with basic electronic knowledge. In the event of failure, they can be easily repaired

SPECIFICATIONS

Supply Voltage: 230VAC, 115VAC +/- 10%
Output Voltage: 24VDC
Output Current: 30mA per channel
No. Of Channel: Four
Operating Temperature: -20 to 60°C
Casing: ABS shell
Polycarbonate Cover
Enclosure: IP10
Terminal size: 2.5mm² cable
Mounting: DIN rail or panel mount

DIMENSIONS

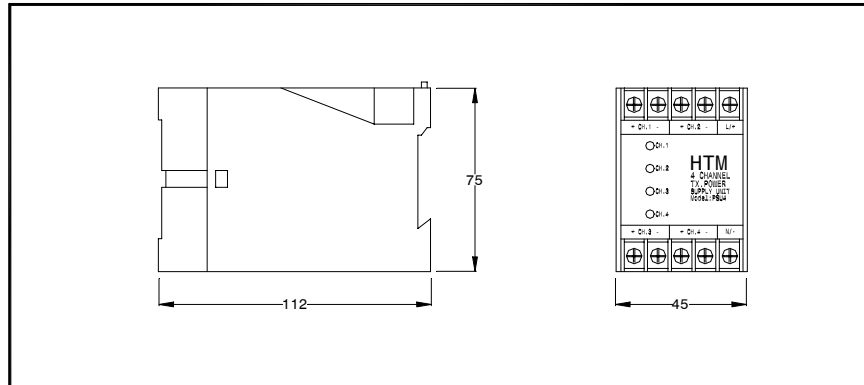

WIRING DIAGRAM

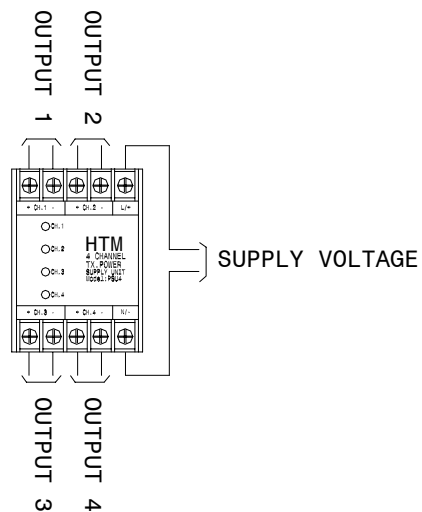

All Dimensions in MM

All Rights reserved

Manufactured by :

HTM Instruments Sdn Bhd (Company No 687564-T)
29, Jalan SG 10/4, Taman Seri Gombak,
68100 Batu Caves, Selangor, Malaysia.